

Pompy przystosowane do współpracy z dyszami Vulcano, Geiser i Campana. Zasady współpracy są omówione na stronach dotyczących tych dysz. Jednak to nie wyklucza zastosowania tych pomp do współpracy z innymi dyszami.

Dane techniczne:

SUBMERSIBLE PUMPS FOR FOUNTAINS AND WATER FEATURES

The VERSAILLES pumps have been designed for fountains, water features and waterfalls in water gardens.

Design Features

- Stainless steel pump casing
- Stainless steel suction grid, plate and base
- Die Cast stainless steel impeller
- 10m H07 RN-F power supply cable with plug in the single phase 220 V 50Hz version
- Fixed double NBR 70 rubber seal with special sand guard V-ring
- Oil chamber for seal lubrication
- Stainless steel shaft with ceramic facing at the points of wear
- Equipped with 1" F plastic reducer

Motor

- Dry motor with stainless steel casing
- Level of protection IP68
- Class F insulation
- Single phase power supply with capacitor permanently activated
- Thermal protection built into the motor winding
- Completely insulated cable connection chamber
- Self-lubricating ball bearings
- Speed of rotation 2850 rpm
- Suitable for continuous use

Usage Limitations

- Type of liquid: clear water, free of solids
- Maximum liquid temperature 40°C
- Maximum submersion under the water level 7m
- Free 1.5 mm clearance. For water features with a lesser clearance insert the sponge filter (optional) in the hydraulics

Applications

- For fountains, water features, waterfalls in water gardens

Accessories (optional)

- Vulcano: adjustable water feature with three level jets
- Geiser: adjustable water feature with a single foamyjet
- Campana: adjustable bell-shaped water feature
- Filters: sponge to be used for water features with clearances under 1.5 mm

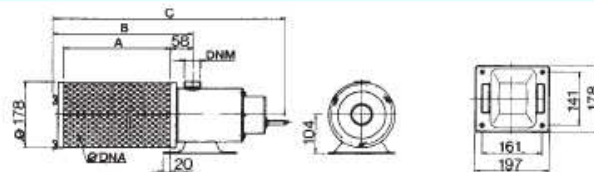
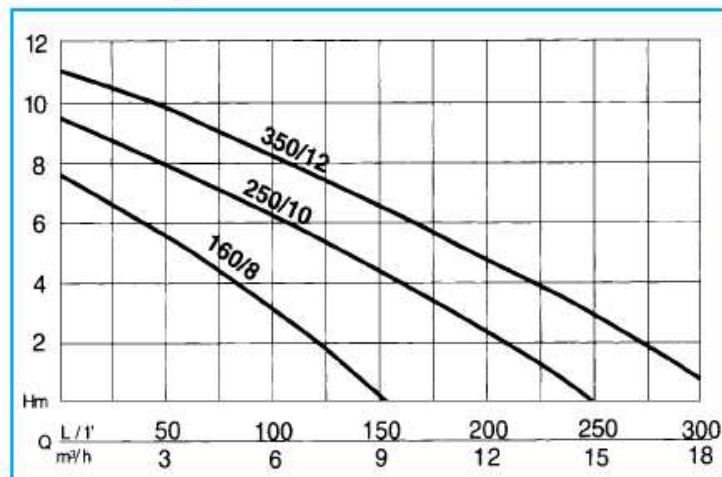

Model	Dimensions mm.					Weight Kg
	A	B	C	Free Clearance	DNM	
VERSAILLES 160/8	144	231	425	Ø 1,5	1 1/4"	7
VERSAILLES 250/10	285	372	620	Ø 1,5	1 1/4"	7,8
VERSAILLES 350/12	285	372	620	Ø 1,5	1 1/4"	9,3